



# **Columbia Gorge Regional Community Health Improvement Plan Progress Report**

June 30, 2022

---

# Table of Contents

<b>Background</b> .....	<b>1</b>
<b>Progress Highlights</b> .....	<b>2</b>
<b>Progress and Indicators by Priority Area</b> .....	<b>5</b>
Housing.....	<b>5</b>
Food.....	<b>7</b>
Transportation and Mobility.....	<b>9</b>
Physical Activity and the Outdoors.....	<b>10</b>
Youth Safety.....	<b>11</b>
Early Childhood Development and Child Care.....	<b>13</b>
Sense of Community.....	<b>14</b>
Collaboration and Information Sharing.....	<b>16</b>
Primary Care.....	<b>18</b>
Dental Care.....	<b>20</b>
Behavioral Health Care.....	<b>21</b>
Health Care Coverage.....	<b>24</b>
Promotion and Prevention.....	<b>25</b>
<b>Appendices</b> .....	<b>27</b>
A: Table of Indicators by Priority Area.....	<b>27</b>
B: CHIP Partners Who Contributed to the Progress Report .....	<b>34</b>
C: Documents Reviewed for the Progress Report.....	<b>35</b>

**Acknowledgements:** The 2022 Progress Report could not have been completed without the support of numerous community partners, who also supported the creation of the 2020 CHIP and continue to play a key role in the implementation of its goals. Thanks to Insight for Action for supporting this work. A list of all CHP partners who contributed to this progress report can be found in Appendix B.

## BACKGROUND

The 2020 Columbia Gorge Community Health Improvement Plan (CHIP) targets 13 priority areas across seven counties along the Columbia River (Hood River, Wasco, Gilliam, Sherman and Wheeler counties in Oregon plus Skamania and Klickitat counties in Washington) that is home to approximately 84,000 people. The 2020 CHIP was a collaborative process with key stakeholders including community-based organizations, healthcare organizations, CCO and community members. The CHIP reflects strategies and goals from a community-wide perspective. The Columbia Gorge CCO’s Community Advisory Council received an update about this Progress Report in May 2022 and reviewed in June 2022. The CCO will create a plain language summary document that will be available in English and Spanish by September 2022.

This report highlights progress made across those **13 priority areas** including a summary of strategies executed and 27 quantitative indicators. We gathered information from 32 stakeholders across the priority areas and reviewed 41 documents. We chose to report progress on priority areas (rather than by goals) so that stakeholders can understand the big picture of progress.



The indicators selected are those the Coordinated Care Organization (CCO) has prioritized and is committed to monitoring progress. Baseline and follow-up data were reported for most (74%) of the 27 indicators. In cases where data were not identified for this report, we intend to identify and report next year. We used four criteria to select indicators.

- ✓ Indicator measures changes in outcomes (i.e., people’s behavior, policies) – not program implementation.
- ✓ Indicator measures progress towards the priority area.
- ✓ Data are available to measure changes in the indicator annually.
- ✓ Community stakeholders prioritized the indicator.

Columbia Gorge Health Council has contracted with Conduent to design a publicly-facing web-based platform “aka HCI Platform” to share data on indicators selected for this CHIP as well as other data for conducting community health needs assessments. As a part of this web-design process, we will compare our indicators with other similar CHIP indicators and make adjustments as needed. We will work with community stakeholders to design a platform that continues to support a collaborative approach to the CHIP. We expect this web-based platform to be up and running by June 1, 2023.



## PROGRESS HIGHLIGHTS

Few changes were made in priorities articulated in the 2020 CHIP. However, across the 13 priority areas, the COVID-19 pandemic continued to dampen efforts and necessitate adjustment of strategies. Workforce shortage, turnover, and burnout were common challenges across healthcare-focused priority areas, including Primary Care and Behavioral Health Care. Across many priorities, existing programs and services slowed down, shifted to virtual or hybrid formats, or halted temporarily or permanently. New programs and services were also developed to meet emerging community needs. Despite the challenges of the pandemic, community partners adapted to continue advancing priorities.

Despite the pandemic, progress was made across all 13 priority areas as indicated in the next section. Notable progress includes One Community Health’s La Clínica Mobile Medical Clinic, Mid-Columbia Community Action Council’s emerging Navigation Center, Columbia Gorge Food Bank’s new Community Food Center, the Columbia Gorge Behavioral Health Advisory Committee, and One Community Health’s School-Based Behavioral Telehealth Services.

### La Clínica Mobile Medical Clinic: Expanding Access to Quality and Affordable Health Care Throughout the Gorge

In spring 2022, One Community Health (OCH) launched a new mobile clinic – named La Clínica after OCH’s name from 1986 to 2013 – in the Columbia Gorge. La Clínica provides medical and behavioral health care in multiple underserved locations throughout the Gorge including



Native American in-lieu sites, homeless shelters, farmworker communities, and schools. Services include pediatric care, immunizations, chronic disease management, substance use support, and resource navigation. Services are provided by a bilingual team of OCH staff including a family nurse practitioner, a community health worker, and a certified medical assistant. The clinic has served 265 patients since May 2022.

## Navigation Center in The Dalles: An Emerging, One-stop Service Center for People Working to Transition to a Stable Home

Mid-Columbia Community Action Council (MCCAC) is in the process of developing a Navigation Center in The Dalles. The 14,000 square foot, multi-agency center will serve as a comprehensive resource center for low-income community members and people experiencing



houselessness. Several agencies will provide services at the center including The Next Door, Inc., the Housing Authority, the Oregon Human Development Corporation, Mid-Columbia Center for Living, One Community Health, and Nch'i Wana Housing. The center will also include a computer lab to support people seeking job and employment opportunities and become the new permanent location of The Dalles shelters for those experiencing houselessness.

## A New Community Food Center: Columbia Gorge Food Bank Expands its Space and Services

Columbia Gorge Food Bank (CGFB) is renovating a 10,000 square foot warehouse in The Dalles into a Community Food Center. The new warehouse – a significant expansion from CGFB's current, 2,000 square foot facility – will include a 1,300 square foot cooler that can store an entire truckload of produce, flex space for community partners to use, and an almost 450 square foot community room where community cooking and nutrition education classes can be held. The warehouse will be completed in December 2022.

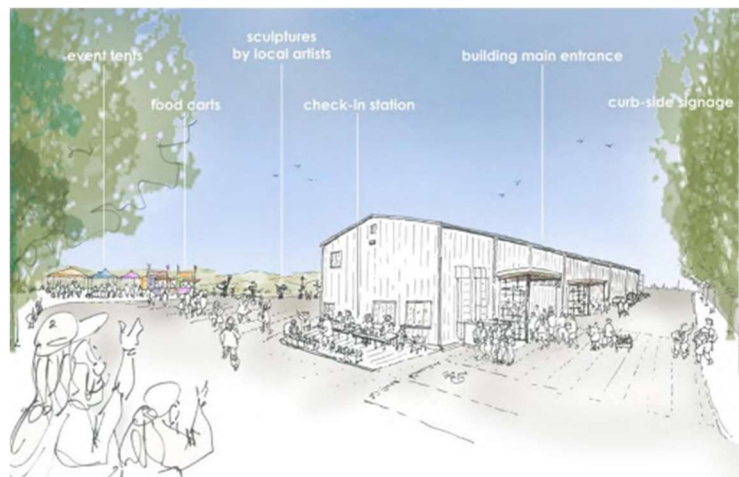

## Behavioral Health Advisory Committee: A Collaborative Focused on Addressing Behavioral Health System Issues in the Gorge

CGHC and PacificSource Community Solutions convened the Behavioral Health Advisory Committee on July 20, 2021. This committee is a collaborative of people representing the



behavioral health community across the Gorge including representatives from behavioral health provider organizations, social service agencies, the Coordinated Care Organization (CCO), and members with lived experience from the Community Advisory Council (CAC). This group is the first to form in the Columbia Gorge with the specific aim of addressing behavioral health system issues. The group is currently working on potential strategies to address workforce development issues to improve equitable access to behavioral health care services. Once these strategies are determined, the group will raise these to the Clinical Advisory Panel (CAP), the Health Council's Board of Directors, and the state of Oregon to request funding and resources to implement.

## Behavioral Telehealth Services: Expanding Access to Behavioral Health Care for Youth in Wasco and Hood River Counties

Behavioral telehealth services are now offered in several middle and high schools in Wasco and Hood River Counties, allowing youth to access credentialed behavioral health professionals while at school. Services



are provided by One Community Health (OCH) behavioral health providers and coordinated by Columbia Gorge Education Service District (CGESD). Three students have received services since they began in February 2022. OCH is organizing a formal back-to-school campaign before the 2022-23 school year to highlight these services for youth and families.



## PROGRESS BY PRIORITY AREA

### 1 Housing



#### Strategy Updates

##### **People can access and afford safe housing.**

- Mid-Columbia Community Action Council (MCCAC) received a \$3.1 million grant in 2021 to provide homeless services to Wasco, Hood River, and Sherman counties. The grant was issued through Oregon Housing and Community Services using federal funds from the Emergency Solutions Grants (ESG) COVID-19 program. MCCAC's grant application was the highest scoring grant in the 26-county rural region.
- MCCAC applied for the grant with six other agencies –The Next Door, Inc., Nch'i Wana Housing, the Oregon Human Development Corporation, Hood River Shelter Services, Bridges to Health, and the Mid-Columbia Housing Authority – with a heavy focus on shelter, street outreach, and culturally specific community engagement. Culturally specific organizations are conducting outreach to Native, Latino/a, and agricultural communities experiencing houselessness in the Gorge.
- In 2021, 17 homes were weatherized through MCCAC's weatherization program, improving home energy efficiency, and resulting in healthier homes, overall. Seventy-six percent of households served were Latino/a.
- In 2021, 2,713 people were served through MCCAC's utility assistance programs. Forty-six percent of participants were, Native, People of Color, or Latino/a.
- MCCAC received \$1.5 million in funding through the 2021 budget reconciliation bill to help develop a Navigation Center in The Dalles. The center will serve as a comprehensive resource center for low-income community members and those experiencing houselessness in the region. Several agencies will provide services at the center including The Next Door, Inc., the Housing Authority, the Oregon Human Development Corporation, Mid-Columbia Center for Living, OCH, and Nch'i Wana Housing. The center will also include a computer lab and become the new permanent location of The Dalles tiny home shelters.
- MCCAC is in the process of developing 75 new affordable and permanent supportive housing units with a focus on serving formerly homeless Veterans, Native community members, and those with behavioral health conditions.

##### **People do not worry about losing their housing.**

- Hood River Shelter Services opened a new location for the 2021-22 season with funding for site development and staffing costs provided by MCCAC.
- The pallet-home homeless shelter in The Dalles was opened during the COVID-19 pandemic. Through grant funding awarded to MCCAC, the 36-bed shelter will remain operational year-round.
- Columbia Area Transit (CAT) and The LINK offer transportation to and from shelters in Wasco and Hood River Counties.
- MCCAC's shelter programs provided over 22,000 nights of shelter across three counties in 2021, a significant increase from around 5,500 nights of shelter provided in 2020.

Indicator	Data Source	Baseline Data (Year)	Progress Data (Year)
Increase number of homeless veterans placed in permanent housing in the Gorge	Point-in-Time Count; Mid-Columbia Community Action Council	24 homeless Veterans in the Columbia Gorge (2019)	Mid-Columbia Community Action Council (2021): <ul style="list-style-type: none"> <li>Placed five veterans into permanent housing units in the Dalles</li> <li>Prevented homelessness for three veterans by providing veteran renter assistance</li> </ul>
Decrease number of individuals experiencing houselessness	Point-in-Time Count Mid-Columbia Community Action Council	Number of people experiencing houselessness (January 2020): <ul style="list-style-type: none"> <li>Hood River County: 56</li> <li>Wasco County: 112</li> <li>Sherman County: 11</li> </ul>	Number of people experiencing houselessness (January 2022): <ul style="list-style-type: none"> <li>Hood River County: 71</li> <li>Wasco County: 194</li> <li>Sherman County: 4</li> </ul> <p><i>Note: Increase in outreach efforts to houseless people may have contributed to increased counts.</i></p>
Decrease number of cost-burdened and rent-burdened households  (Note: Cost or rent-burdened = greater than 30 percent of gross household income is spent on monthly owner costs or gross rent)	American Community Survey (U.S. Census Bureau, Table ID: <a href="#">DP04</a> )	Total cost-burdened households with a mortgage (2019): <ul style="list-style-type: none"> <li>Hood River County: 27.8% (n = 888/3,196)</li> <li>Wasco County: 29.7% (n = 1,098/3,703)</li> </ul> Total cost-burdened households without a mortgage (2019): <ul style="list-style-type: none"> <li>Hood River County: 11.4% (n = 292/2,571)</li> <li>Wasco County: 12.3% (n = 327/2,670)</li> </ul> Total rent-burdened households (2019): <ul style="list-style-type: none"> <li>Hood River County: 40.3% (n = 971/2,409)</li> <li>Wasco County: 36.4% (1,277/3,510)</li> </ul>	Total cost-burdened households with a mortgage (2020): <ul style="list-style-type: none"> <li>Hood River County: 30.6% (n=1,047/3,427)</li> <li>Wasco County: 30.4% (n = 1,157/3,800)</li> </ul> Total cost-burdened households without a mortgage (2020): <ul style="list-style-type: none"> <li>Hood River County: 11.6% (n=305/2,640)</li> <li>Wasco County: 12.2% (n=344/2,822)</li> </ul> Total rent-burdened households (2020): <ul style="list-style-type: none"> <li>Hood River County: 38.4% (n = 914/2,382)</li> <li>Wasco County: 34.3% (n =1,169/3,413)</li> </ul>
Increase number of affordable rental ownership opportunities available	<a href="#">Affordable Rental Housing Dashboard</a> by Oregon Housing and	OHCS-funded properties (as of December 2020): <ul style="list-style-type: none"> <li>Hood River County: 26 total units, 10 total projects</li> </ul>	OHCS-funded properties (as of December 2021): <ul style="list-style-type: none"> <li>Hood River County: 26 total units, 10 total projects</li> <li>Wasco County: 24 total units, 3 total projects</li> </ul>



	Community Services (OHCS)  (via <a href="#">Oregon Housing Data &amp; Analysis</a> )	<ul style="list-style-type: none"> <li>Wasco County: 24 total units, 3 total projects</li> </ul>	
--	--	--	--



## 2 Food



### Strategy Updates

#### All people can access and afford healthy food.

- Columbia Gorge Food Bank (CGFB) received funding to renovate a 10,000 square foot warehouse in The Dalles into a Community Food Center. The new warehouse – a significant expansion from CGFB’s current, 2,000 square foot facility – will include a 1,300 square foot cooler to store food, flex space for community partners to use, and a community room to host classes such as nutrition education and cooking classes. The warehouse will be completed in December 2022.
- CGFB received funding from the Roundhouse Foundation to purchase a new food delivery truck, which will arrive in July 2022.
- CGFB continues to support and strengthen the community food system. Last year, they purchased products from farmers in South Wasco County for delivery to food pantries within the county.
- CGFB provided \$5,000 in SNAP match funding to The Dalles Farmers Market. The funding enables participants to purchase more fresh food from local farmers.
- CGFB furnished \$5,000 in grant funding to TNDI to provide propane vouchers to Native American communities living on the river.
- CGFB serves about 5,000 people per month across over 30 programs spread across Hood River, Wasco, and Sherman counties, including expanded rural food distributions to food pantries in Rufus, Maupin, and Womack.
- CGFB increased their number of partner agencies by 20% and doubled the amount of food distributed since last year.
- The Oregon Food Bank Equity (OFB) and Racial Justice team developed and conducted a pilot equity assessment to learn how they can provide better, more dignified, equitable service to people in need. Community partners including The Next Door, Inc., Oregon Child Development Coalition, Oregon Housing Authority, and OCH supported OFB in distributing the surveys, particularly to Native American and Latino/a communities. There were over 450 respondents to the survey, all of whom received a \$25 incentive.
- The Gorge Grown Mobile Farmers Market brings 100% locally grown fruit and vegetables to communities throughout the Gorge. In 2022, 25% of mobile market produce was sold to economically disadvantaged customers using nutrition incentives such as SNAP and WIC. Gorge Grown Food Network is also providing a 25% discount to those in need but not eligible for assistance.

- The Gorge Grown Mobile Farmers Market added three stops to new communities in the past year, and now has 11 regular stops in five counties. As of May 2022, the Mobile Market is at maximum capacity with its current staffing and one vehicle.
- A new community garden will be established in 2022 as a result of the Food Security Coalition FEAST project in Odell.
- Since June 2021, the following school districts received Oregon Farm to School funding to reimburse them for local food purchases: Hood River (\$24,640), Wasco (\$25,640), and Sherman (\$1,687) Counties.
- During the June 2019-2021 biennium, Wasco County secured \$69,222 and Hood River County secured \$20,450 for Farm to School infrastructure or education grants, which helped farmers scale production for wholesale to schools.
- In the last couple of years, there has been a significant rise in the number of checkouts for food preservation/processing equipment through the OSU Extension rental program at Hood River Library. There were 329 total rentals between May 2019 and October 2021. The top five pieces of equipment rented out were 63 small dehydrators, 46 cherry pitters, 40 large dehydrators, 31 canners, and 27 steam juicers.

 **Food Indicators**

Indicator	Data Source	Baseline Data (Year)	Progress Data (Year)
Decrease rate of food insecurity	<a href="#">Feeding America: Map the Meal Gap</a>	Food insecurity rate and number of food insecure people by county (2019): <ul style="list-style-type: none"> <li>▪ Hood River: 6.6% (n = 1,540)</li> <li>▪ Wasco: 11.8% (n = 3,080)</li> <li>▪ Gilliam: 12.1% (n = 230)</li> <li>▪ Sherman: 13.4% (n = 220)</li> <li>▪ Wheeler: 13.6% (n = 190)</li> </ul>	The most recent data release is based on data from 2019, before COVID-19. In 2021, Feeding America released data on <i>projected</i> changes in food insecurity as a result of COVID-19. Projected food insecurity rates by county (2021): <ul style="list-style-type: none"> <li>▪ Hood River: 7.9%</li> <li>▪ Wasco: 12.8%</li> <li>▪ Gilliam: 13.1%</li> <li>▪ Sherman: 14.1%</li> <li>▪ Wheeler: 13.7%</li> </ul>



### 3 Transportation and Mobility



#### Strategy Updates

**Public and private transportation is available and convenient for all activities that support and encourage health, daily living, physical activity, and wellbeing.**

- The Next Door, Inc. (TNDI), Columbia River Inter-Tribal Fish Commission, and One Community Health (OCH) partnered to host COVID-19 vaccine clinics and conduct vaccine-related outreach to Native American communities in the Gorge. Mid-Columbia Economic Development District (MCEDD) organized free transportation to vaccine appointments.
- The Gorge Pass is a low-cost, annual transit pass that provides unlimited rides to and from Portland/Vancouver and around the Columbia River Gorge. A portion of pass proceeds is contributed to the Gorge Equity Fund which provides passes to eligible individuals with a household income at 138% or less of the Federal Poverty Level.

**Public and private transportation is safe and meets the needs of each person.**

- MCEDD’s (Mid-Columbia Economic Development District) Mobility and Travel Training Program Manager works with LINK Public Transit and Columbia Area Transit to teach local, rural, and underserved populations how to use public transit services in Wasco and Hood River counties. 50+ people have been reached since October 2021.

**Communities have safe transportation and infrastructure that supports walking, biking, and wheelchair and walker rolling.**

- Hood River Valley School District and North Wasco School District received planning grants from the Oregon Department of Transportation (via Mid-Columbia Economic Development District) to support implementation of Safe Routes to School (SRTS) programming, which will improve conditions for children to walk and bike to school.



#### Transportation and Mobility Indicators

Indicator	Data Source	Baseline Data (Year)	Progress Data (Year)
Increase number of Gorge Passes provided to low-income people in the Gorge	Columbia Area Transit	No baseline data available.	Number of Gorge Passes distributed since July 2021: <ul style="list-style-type: none"> <li>▪ Hood River County = 256</li> <li>▪ Wasco County = 196</li> </ul>



## 4 Physical Activity and the Outdoors



### Strategy Updates

**All people have opportunities for physical activity that supports their health and wellbeing. This is regardless of their race, ethnicity, physical limitation, or where they live.**

- Strong People is an evidence-based program that helps its participants increase their joint flexibility, muscle strength, balance, and overall wellbeing. The program is offered through Oregon State University (OSU) Extension Family and Community Health to 21 groups across 9 counties in Oregon and Southern Washington, including counties of the Columbia Gorge. During the COVID-19 pandemic, program leaders adapted to provide virtual classes and exercise videos to participants. Their videos, which have been promoted on YouTube, have received over 2,000 views. The program served as a physical and social-emotional protective factor for participants in a time of social isolation.
- CultureSeed continues to offer physical and behavioral health programming for youth at NORCOR including yoga, meditation, walks, and behavioral health groups.
- CultureSeed established its Outdoor Mentorship Program during the COVID-19 pandemic. The program offers an opportunity for caring adults to support youth in getting outside while building a long-term supportive relationship. The program is one way that CultureSeed supports youth experiencing loneliness, disconnection, trauma, and other challenges by providing connection and the healthful benefits of nature.

**It is easy for people to access parks, trails, and natural areas for exercise & social activities.**

- North Wasco Parks and Recreation received over \$3 million in funding to support construction of the Mill Creek Greenway. Funds will be used to build a fully accessible bike and pedestrian path from West Second Street to West Sixth Street in The Dalles to facilitate equitable access to parks and commercial areas for all residents.



### Physical Activity Indicators

Indicator	Data Source	Baseline Data (Year)	Progress Data (Year)
Decrease percent of 8 <sup>th</sup> and 11 <sup>th</sup> graders who are overweight or obese	Oregon Student Health Survey (SHS) ( <a href="#">County Reports</a> and <a href="#">Data Dashboard</a> )	Percent 8th and 11th graders who are overweight (2020): <ul style="list-style-type: none"> <li>▪ Hood River County: 15.9% 8th graders, 14.1% 11<sup>th</sup> graders</li> <li>▪ North Central Health District (Sherman and Wasco Counties): 15.5% 8th graders, 19.2% 11th graders</li> </ul> Percent 8th and 11th graders who are obese (2020): <ul style="list-style-type: none"> <li>▪ Hood River County: 12.1% 8th graders, 8.2% 11<sup>th</sup> graders</li> <li>▪ North Central Health District (Sherman and Wasco Counties): 21.0% 8th graders, 18.4% 11th graders</li> </ul>	The SHS launched in schools with 6th, 8th and 11th graders in the fall of 2020 and will occur every even-numbered year. The next period of data collection is fall 2022.



**Youth (ages 0 to 18) feel respected, safe, and supported: in their homes, getting to and from school, in school, and in community activities.**

- As of January 1, 2022, a tobacco retail license is required of any retailer in the state of Oregon that sells any tobacco or inhalant delivery system (IDS) product such as cigarettes, cigars, chewing tobacco, e-cigarettes and vape products, or any other item designed for the consumption, use, or preparation of tobacco products. The new law is an important step toward reducing tobacco use among youth. North Center Public Health District received a Tobacco Prevention and Education Program Grant (via OHA) to educate retailers on requirements of the new law. Sixteen people attended the training. ([Source](#))
- Hood River County School District and Hood River Juvenile Department are interested in partnering to establish the Tobacco, Marijuana, and E-Cigarette Course (TMEC) as a restorative justice practice in middle and high schools in the county. The curriculum (via Clear Alliance) focuses on health, safety, and impaired driving education, and would be an alternative activity to school suspension.
- YouthThink has implemented Teen Intervene trainings in Dufur School District, Youth Empowerment Shelter (YES) House, Northern Oregon Correctional Facilities (NORCOR), and Wasco County Juvenile Department. Teen Intervene is a brief, early intervention program for 12–19-year-olds who display the early stages of alcohol or drug involvement. The training is in full compliance of the Screening, Brief Intervention, and Referral to Treatment (SBIRT) model.
- Four Hood River School District staff have received training on the Not on Tobacco (N-O-T) Program, a teen smoking and vaping cessation program. Cessation supports are provided to youth through the school-based health center at Hood River Valley High School.

**Youth have equitable access to activities to play, learn, and grow outside of school that their families can afford.**

- See strategies detailed in Physical Activity and the Outdoors.

**There is infrastructure and there are opportunities so that youth of all ages, abilities, and interests have a variety of physical and other activity options that are offered in an equitable way.**

- See strategies detailed in Physical Activity and the Outdoors.

**Youth who experience bullying or suffer violence, whether in person or online, are supported and have access to the help they need.**

- As of spring 2022, Columbia Gorge Education Service District (CGESD) coordinates behavioral telehealth services in middle and high schools in Wasco and Hood River Counties. Services are provided by One Community Health (OCH) providers. Three students have received services since

February 2022. One Community Health is organizing a formal back-to-school campaign to highlight these services for children and families before the 2022-23 school year.

- A CultureSeed staff member provides behavioral health services to youth at the Columbia High School Health and Wellness Center in White Salmon Valley School District. Anecdotally, the presence of trusted adults and services offered in the Center has increased youth sense of place and safety within the school.
- CultureSeed recently onboarded four contract therapists who will help expand the organization’s capacity to provide 1:1 psychotherapy services for youth. Fifty percent of the contracted therapists are People of Color and will support efforts to reach and connect with more Black, Indigenous, and People of Color (BIPOC) youth.
- CultureSeed established its Outdoor Mentorship Program during the COVID-19 pandemic. The program offers an opportunity for caring adults to support youth in getting outside while building a long-term supportive relationship. The program is one way that CultureSeed supports youth experiencing loneliness, disconnection, trauma, and other challenges by providing connection and the healthful benefits of nature.

 Youth Safety Indicators

Indicator	Data Source	Baseline Data (Year)	Progress Data (Year)
Decrease percent youth who identify mental and behavioral health challenges as top concerns facing students in schools	Baseline data: Youth & Parent Survey (Wasco County, December 2020)  Progress data: YouthThink, <a href="#">Search Institute Developmental Relationships Survey</a>	In the Youth & Parent Survey administered for the School Health Services Planning Grant in Wasco County (December 2020), youth identified the top three health concerns facing students in schools as: 1) Mental health: feeling sad, stressed, thinking about hurting yourself, 2) Alcohol or drug use, and 3) Smoking, vaping.	In 2022-23, YouthThink will begin administering the Search Institute Developmental Relationships Survey for 4 <sup>th</sup> to 12 <sup>th</sup> grade students and staff in Wasco County. The survey will provide ongoing data on youth and adults perceptions of student mental and behavioral health.
Decrease percent parents who are concerned about their child's mental health and behavioral health	YouthThink  Baseline data: Youth & Parent Survey (Wasco County, December 2020)	Prior to the COVID-19 pandemic, YouthThink conducted yearly parent surveys at elementary and middle schools to identify parent concerns and perceptions of their child’s health. The survey has collected over 600 responses. During the COVID-19 pandemic, the Youth & Parent Survey administered for the School Health Services Planning Grant in Wasco County (December 2020) asked parents questions on the impact of COVID-19 on their children. 58% of parents reported their child seems sad or lonely from being unable to see their friends or people they care about due to COVID-19.	The parent survey administered by YouthThink will be resumed in the 2022-23 school year.



## 6 Early Childhood Development and Child Care

### Strategy Updates

#### **People can access culturally and linguistically appropriate, high quality, affordable childcare when and where they need it.**

- Mid-Columbia Children’s Council (MCCC) serves children and families in Skamania, Klickitat, Wasco, and Hood River Counties. They currently operate 21 preschool classrooms, seven infant-toddler classrooms, and six home-based programs for children 0-3 years old across the four counties.
- MCCC expanded its capacity to provide childcare by 51 slots by adding three preschool classrooms (36 slots) at Westside Elementary School in Hood River County and one preschool classroom (15 slots) at an elementary school in Wasco County. They have been approved to add 18 more slots at Wishram Elementary School in Klickitat County next school year.
- MCCC operates three dual-language (Spanish and English) preschool classrooms, including one of the three newly added classrooms at Westside Elementary School. MCMC ensures classrooms with Latino/a children have at least one Latino/a adult in the classroom.

#### **People can access and afford early childhood development supports and opportunities such as early intervention, home visiting, group socialization, preschool, and activities.**

- In the last year, MCCC conducted vision screenings for 387 children. Forty-four children were referred for treatment and of those, 19 children received glasses. Fifteen did not need glasses but are being monitored. Ten have yet to see a doctor and are receiving support from MCCC to schedule appointments.
- MCCC recently started offering tuition-based preschool so that more families can take advantage of the preschool experience. Eighteen tuition-based slots have been added in Hood River County, and three slots have been added in Wasco County.
- Since 2021, six children who did meet the eligibility requirements to participate in MCCC’s preschool programs were funded to participate in the programs through the Hood River County School District Migrant Education Program.
- Fifteen parents of children participating in an MCCC program participate in the Parent Policy Council. The council guides organizational decision-making “regarding activities that promote parent involvement in program operations, responsiveness to community needs, and program activities.” ([Source](#))



## Early Childhood Development and Child Care Indicators

Indicator	Data Source	Baseline Data (Year)	Progress Data (Year)
Increase number of elementary school zones that offer options for high quality childcare programs that represent the demographics of the zone	Mid-Columbia Children’s Council (MCCC)	No baseline data available.	MCCC operates 21 preschool classrooms, 7 infant toddler classrooms and 6 home-based models (for 0-3 year olds) in four counties: Skamania, Klickitat, Wasco, and Hood River. Their programs reach all elementary school zones in the four counties they serve (2022).



## 7 Sense of Community



### Strategy Updates

#### **People feel a sense of connection, security, belonging, and trust in their community.**

- CultureSeed recently onboarded four contract therapists who will help expand the organization’s capacity to provide 1:1 psychotherapy services for youth. Fifty percent of the contracted therapists are People of Color and will support efforts to reach and connect with more Black, Indigenous, and People of Color (BIPOC) youth.
- A CultureSeed staff member provides behavioral health services to youth at the Columbia High School Health and Wellness Center in White Salmon Valley School District. Anecdotally, the presence of trusted adults and services offered in the Center has increased youths’ sense of place and safety within the school.
- As of spring 2022, Columbia Gorge Education Service District (CGESD) coordinates behavioral telehealth services in middle and high schools in Wasco and Hood River Counties. Services are provided by One Community Health (OCH) providers. Three students have received services since February 2022. One Community Health is organizing a formal back-to-school campaign to highlight these services for children and families before the 2022-23 school year.
- With support from CGESD, Dufur School District applied for a school-based health center planning grant and recently established a committee to begin the planning process and conduct a needs assessment.
- CGESD and North Central Education Service District are in discussion about partnering to provide school-based nursing services to schools in South Wasco and Sherman School Districts.

#### **People receive social support from family, friends, and other community members.**

- CultureSeed continues to offer internships to Portland State University clinical social work students. In the next year, CultureSeed will have an intern from the Master of Social Work program who will take over LGBTQIA+ outreach and the organization’s work with NORCOR.



- CGESD holds quarterly advisory council meetings for community partners in the region. A large focus of their recent meetings has been on addressing mental health stigma and identifying ways to provide continued mental health support for people in the region.
- Supported by funding from an OHA grant, CGESD has partnered with Bridges to Health to hire a community health worker who will work alongside school-based nurses in Wasco County to provide physical, mental, and social supports to students.

**People feel a sense of community through access to parks, nature, and recreation.**

- Transportation remains one of the largest barriers for youth in the Gorge. In Spring 2022, CultureSeed purchased a van that will help more youth participate in its programming. The van transports youth to and from White Salmon Youth Center which is centrally located in Klickitat County. Since 2021, CultureSeed has served over 60 Klickitat County youth through its outdoor mentorship program, outdoor education program, and behavioral health services.

**People and groups get support in growing as leaders. They feel they have a voice and can contribute to their community.**

- CultureSeed Junior Council members continue to advise organization strategy and plan and lead advocacy projects that address the intersections of social justice, health equity, and the outdoors. Youth on the council spearheaded the fundraising campaign for the new CultureSeed van.

 **Sense of Community Indicators**

Indicator	Data Source	Baseline Data (Year)	Progress Data (Year)
Decrease percent of 8 <sup>th</sup> and 11 <sup>th</sup> graders who are bullied going to or at school	Oregon Student Health Survey (SHS) ( <a href="#">County Reports</a> and <a href="#">Data Dashboard</a> )	Percent 8th and 11th graders bullied in the past 30 days AT SCHOOL (in-person OR via social media, phones, gaming) <ul style="list-style-type: none"> <li>▪ Hood River County: 8.2% 8th graders, 11.4% 11th graders</li> <li>▪ North Central Health District (Sherman and Wasco Counties): 7.7% 8th graders, 21.3% 11th graders</li> </ul> <i>Note: County-level data was not available for Gilliam County.</i>	The SHS launched in schools with 6th, 8th and 11th graders in the fall of 2020 and will occur every even-numbered year. The next period of data collection is fall 2022.
Decrease percent of 8 <sup>th</sup> and 11 <sup>th</sup> graders who miss school because they feel unsafe	Oregon Student Health Survey (SHS) ( <a href="#">County Reports</a> and <a href="#">Data Dashboard</a> )	Percent 8th and 11th graders who did not go to school in the past 30 days because they felt they would be unsafe at school or on their way to or from school (2020): <ul style="list-style-type: none"> <li>▪ Hood River County: 3.8% 8th graders, 2.6% 11th graders</li> <li>▪ North Central Health District (Sherman and Wasco Counties): 10.2% 8th graders, 7% 11th graders</li> </ul> <i>Note: County-level data was not available for Gilliam County.</i>	The SHS launched in schools with 6th, 8th and 11th graders in the fall of 2020 and will occur every even-numbered year. The next period of data collection is fall 2022.



## 8 Collaboration and Information Sharing



### Strategy Updates

**People get the language appropriate information they need or want on paper, online, or video to be able to access the services they need.**

- PacificSource’s Health Equity Plan emphasizes culturally and linguistically appropriate services (CLAS) Standards. There have been trainings to both the Board of the CCO and Community Advisory Council about CLAS Standards.
- Columbia Gorge CCO hosted a free interpreter training to increase the number of certified and trained interpreters in the Columbia Gorge.
- The Hood River Prevention Department launched an online version of a comprehensive Resource Directory for the Columbia River Gorge available to anyone. This is a static directory where people can search for various social, health, and other resources then reach out to the organizations listed that provide those services.

**Organizations coordinate intake and exchange information for shared patients or clients.**

- Both community information exchange (CIE) platforms – Activate Care and Connect Oregon – are currently present in the region. Eleven organizations have onboarded onto a CIE platform with plans to continue to spread adoption throughout the region.
- PacificSource and Columbia Gorge Health Council (CGHC) are working with Activate Care and Connect Oregon to build interoperability between the platforms as adoption spreads in the community.

**Referrals are coordinated and people get their needs met in a timely manner.**

- Social services and healthcare partners in the Gorge are currently exploring Connect Oregon to send closed loop referrals.
- South Wasco Alliance located in southern Wasco County is exploring a Connect Oregon to launch in August 2022.
- Bridges to Health is currently exploring utilizing Connect Oregon to connect clients with PacificSource for flexible services.



### Collaboration and Information Sharing Indicators

Indicator	Data Source	Baseline Data (Year)	Progress Data (Year)
Increase number organizations using an adopted referral system that links healthcare and social services agencies in the Gorge	Pacific Source and Columbia Gorge Health Council	Community Information Exchange (CIE) is expanding across the state with Connect Oregon, and slowly growing in the Columbia Gorge. Activate Care and Connect Oregon are currently present in the region. The Gorge has a regional goal of ensuring platforms used	Connect Oregon, via the Unite Us platform, is currently being explored for adoption in the Gorge for social service and healthcare partners to send closed loop referrals. Organizations in South Wasco County are exploring a pilot to

		<p>have as much interoperability as possible. Currently, PacificSource and CGHC are driving the process of interoperability between Activate Care and Unite Us. As of June 2021, 7 organizations were onboarded to Activate Care.</p>	<p>launch in August 2022. Additionally, Bridges to Health is currently exploring utilizing Connect Oregon to connect clients with PacificSource for flexible services. As of June 2022, there are ten organizations in the Gorge actively using Activate Care.</p>
<p>Decrease percent of unmet client needs across Behavioral Health, Housing, Childcare and Dental</p>	<p>Bridges to Health</p>	<p>The highest percent of client needs unable to be met (incomplete percentages), according to Bridges to Health Program Data (June 2021) were:</p> <ul style="list-style-type: none"> <li>▪ Childcare (20%)</li> <li>▪ Behavioral Health (16%)</li> <li>▪ Dental (15%)</li> <li>▪ Employment (15%)</li> <li>▪ Housing (12%)</li> <li>▪ Medical (5.5%)</li> </ul>	<p>The highest percent of client needs unable to be met (incomplete percentages), according to Bridges to Health Program Data (June 2022) are:</p> <ul style="list-style-type: none"> <li>▪ Employment (22%)</li> <li>▪ Childcare (21%)</li> <li>▪ Behavioral Health (20%)</li> <li>▪ Housing (16.7%)</li> <li>▪ Dental (12.7%)</li> <li>▪ Medical (10.8%)</li> </ul> <p>Dental has improved by 2.3% since June 2021.</p>
<p>Increase number of Bridges to Health program clients successfully navigated to services with an emphasis on under resourced populations (older adults, tribal members, and migrant and seasonal farm workers)</p>	<p>Bridges to Health</p>	<p>During the last quarter in 2020 and the first quarter in 2021, clients of the Bridges to Health Program were navigated successfully to the following services in order of frequency: Food, Financial Assistance, Housing, Social Services, Utility Assistance, Transportation, Medical Visits, and COVID Immunizations. 733 needs were addressed successfully through service navigation.</p>	<p>Since second quarter 2021, clients of the Bridges to Health Program were navigated successfully to the following services: Food, Financial Assistance, Housing, Social Services, Utility Assistance, Transportation, Medical Visits, and COVID Immunizations. 1560 needs were addressed successfully through service navigation.</p>

**People get the primary care they need when they need it.**

- Klickitat County Health Department received two years of funding from the Washington State Department of Children, Youth, and Families to develop a task force to support perinatal mental health community capacity building. The task force includes community partners from Klickitat, Skamania, Wasco, and Hood River counties and is working to raise awareness on perinatal mental health issues, develop community resources and supports for families, and strengthen supports for healthcare and social service providers. The taskforce has received another two years of funding, during which the focus will be to increase provider-level training and education and develop perinatal mental health supports for families.
- “Mid-Columbia Medical Center (MCMC) opened a new Transitional Care Clinic to help patients transition from hospital to home. The clinic is staffed by MCMC hospitalists, physicians who specialize in caring for hospitalized patients and who are uniquely qualified to support patients in the transition of their care after discharge.” ([Source](#))
- Over the last couple of years, MCMC has conducted outreach to approximately 5,000 patients who are overdue for colorectal cancer screenings to encourage them to schedule screenings with their primary care providers. MCMC has seen a 2-3% increase in screening and colonoscopy rates because of this outreach. This increase was driven in part by fixing incorrect documentation on completed colorectal cancer screenings in electronic medical records.
- MCMC is implementing efforts to conduct A1c screenings for all patients with controlled or uncontrolled diabetes earlier in the year. These efforts facilitate early identification of patients with uncontrolled diabetes and create opportunities for providers to support these patients with diabetes management and follow-up for the rest of the year. As of May 2022, approximately 60% of PacificSource Columbia Gorge patients with diabetes have received A1c screenings.

**Primary care is equitable and inclusive, and offered in a respectful and trauma-informed manner.**

- The Perinatal Mental Health Initiative is working to secure funding to support up to 10 people to participate in the Perinatal Mental Health Certification Program, an online certification offered by Postpartum Support International. The taskforce will place an additional focus on training Spanish-speaking providers who can serve Latino/a community members.
- MCMC developed and continues to expand its Patient Navigation program. The program aims to better support patients in navigating the healthcare system, addressing social determinants of health, and accessing resources and supports within the community. The 15 providers in the program include community health workers, social workers, inpatient and outpatient nurses, and navigators.



**Health care is offered in diverse settings, supporting health and wellness at every stage of life.**

- Columbia Gorge Postpartum Support (CGPS) began during the COVID-19 pandemic and offered postpartum doula services and lactation support to families in-home and online. Doula services discontinued in spring 2021 and lactation supports halted in spring 2022 due to lack of funding. In their year and half of operation, CGPS served 80 families and offered almost 160 home visits for lactation support.
- One Community Health (OCH) plans to pick up CGPS’s programs in the future. OCH will offer postpartum support groups and contract with a postpartum doula to offer all OCH clients one postpartum home visit.
- OCH’s Mobile Medical Clinic, La Clínica, provides medical and behavioral health care to people throughout the Gorge. The clinic has served 265 patients since May 2022. Through a partnership with Columbia Gorge Education Service District (CGESD), OCH is in the process of expanding its mobile medical clinic services to Dufur and The Dalles High Schools, which would expand youth access to physical and mental health services including well-child checks, immunizations, and disease management. Services would be provided by licensed clinicians at OCH.



**Primary Care Indicators**

Indicator	Data Source	Baseline Data (Year)	Progress Data (Year)
Decrease percent of patients whose most recent HbA1C level is greater than 9%	Pacific Source Quality Incentive Measure (QIM) Performance Report	Gorge CCO rate of patients’ whose most recent HbA1C level is greater than 9% (2020): 26.4%  Note: CCO performance is measured by data from One Community Health, Mid-Columbia Medical Center, Columbia Gorge Family Medicine and Providence. CCO targets were rebased in August 2021.	Gorge CCO rate of patients’ whose most recent HbA1C level is greater than 9% (2021): 25.4% (Target 33.3%)  Note: CCO performance is measured by data from One Community Health, Mid-Columbia Medical Center, Columbia Gorge Family Medicine and Providence. CCO targets were rebased in August 2021.
Increase or consistent high level (95% or above) of Columbia Gorge CCO members assigned to a patient-centered primary care home (PCPCH)	PacificSource Gorge CCO	Percent members enrolled in the Columbia Gorge CCO who are assigned to a PCPCH (2021): 94%	Percentage members enrolled in the Columbia Gorge CCO who are assigned to a PCPCH (2022): 96%

Increase percent children (age 3-6 <i>and</i> Columbia Gorge CCO members) that receive an annual wellness visit with their Primary Care Provider	PacificSource	Percent children (age 3-6 <i>and</i> Columbia Gorge CCO members) that receive an annual wellness visit with their Primary Care Provider (2021): <ul style="list-style-type: none"> <li>▪ 904 children (71.1% of children enrolled in the CCO)</li> </ul>	Percent children (age 3-6 <i>and</i> Columbia Gorge CCO members) that receive an annual wellness visit with their Primary Care Provider (January-April 2022): <ul style="list-style-type: none"> <li>▪ 351 children (21.8% of children enrolled in the CCO)</li> </ul>
--	---------------	--	--



## 10 Dental Care



### Strategy Updates

#### **People get the dental services they need when they need them.**

- Children 1-5 and pregnant women are priority populations for dental care. Advantage Dental’s Member Outreach team calls 1) the caregivers of all patients ages 1-5, and 2) all pregnant women upon receiving a pregnancy indicator. Member Outreach representatives discuss the importance of oral health care and offer to connect members to their Primary Care Dentist for appointment scheduling, or to do a warm hand-off to a Community Care Expanded Practice Dental Hygienist (EPDH) for an assessment via tele dentistry.
- OCH primary care providers provide oral health services – including conducting an oral health exam and applying topical fluoride varnish – at all well-child visits.

#### **Dental care is equitable, affordable, and inclusive, and offered in a respectful and trauma-informed manner.**

- Advantage Dental’s Community Care team continues to provide dental services in the community setting to promote health equity and reduce barriers to care. The Community Care team currently provides preventive services and toothbrush kits to pregnant women in Hood River and Wasco Counties via WIC programs, and to 1–5-year-olds in Hood River and Wasco Counties via Head Start and OCDC programs. The team also provides First Tooth training to primary care offices in the Columbia Gorge region.
- In the last year, the oral health coalition has provided water bottles with oral health messaging to primary care practitioner (PCP) offices and health departments. Messaging on the water bottle says “drink water for thirst” in English and Spanish.
- The coalition has also provided toothbrush kits donated by Advantage and Oregon Dental Service (ODS) to PCP offices. Providers will distribute toothbrush kits to parents and children during primary care visits.

Indicator	Data Source	Baseline Data (Year)	Progress Data (Year)
Increase percent of Gorge CCO children ages 1-5 who received oral health services	Pacific Source Quality Incentive Measure (QIM) Performance Report	Gorge CCO rate of children receiving oral health services (February 2021): <ul style="list-style-type: none"> <li>Age 1-5: 8.3%</li> </ul>	Gorge CCO rate of children receiving oral health services (December 2021): <ul style="list-style-type: none"> <li>Age 1-5: 40.6% (Target 33.7%)</li> <li>Age 6-14: 59.3% (Target 43.1%)</li> </ul> Gorge CCO rate of children receiving oral health services (April 2022): <ul style="list-style-type: none"> <li>Age 1-5: 15.9% (Target 39.4%)</li> <li>Age 6-14: 20.6% (Target 52%)</li> </ul> <i>Note: CCO targets were rebased in August 2021.</i>



## 11 Behavioral Health Care



### Strategy Updates

**People get the behavioral services and supports they need when they need them including mental health, substance abuse, crisis intervention, inpatient treatment, and outpatient treatment services.**

- Mid-Columbia Center for Living (MCCFL) expanded its Medication Assistance Treatment (MAT) program, which serves individuals experiencing opioid and substance use disorders. Since June 2021, MCCFL has screened and/or treated 70 individuals through the program. MCCFL also expanded its drug, alcohol, and mental health services by promoting three qualified mental health associates and supervising a few professionals who are receiving training to become drug and alcohol counselors.
- TNDI continues to partner with The Dalles High School to operate Kelly Avenue School, a therapeutic school that provides mental health and counseling services and psychological and behavioral skill development to youth who are referred from the high school. The high school places up to 15 youth in the therapeutic school. TNDI is currently regularly providing mental health therapy services to five Kelly Avenue School attendees.
- In 2022, TNDI placed a therapist in Chenoweth Elementary School in The Dalles upon request from the school principal. The therapist has 10 youth on her case load since starting in May and will add up to 20 more. She is also working with clients at Dry Hollow Elementary School and is available to visit Colonel Wright Elementary School if requested by school staff.

- TNDI continues to provide mental health and substance use treatment services to young people and mothers in schools and throughout the community. Six TNDI clinicians are currently serving 92 clients in Wasco and Hood River Counties. Many clients are also served by other programs at TNDI, including the Healthy Families Program, Gorge Youth Mentoring and alternative high schools.
- The PacificSource Behavioral Health Population Health (BPH) team is developing a comprehensive Substance Use Disorder Technical Assistance Toolkit for PacificSource Community Solutions providers. Goals of the toolkit include: 1) clarifying roles and responsibilities for providers in coordinating and providing services for CCO members as they access various ASAM (American Society of Addiction Medicine) levels of care throughout Oregon, 2) identifying gaps and/or barriers in referral and coordination processes between SUD providers and agencies, and 3) increasing internal communication and alignment on best practices and care coordination for members needing supports through policy and procedures, workflows, and ongoing consulting. The toolkit is part of PacificSource’s 2022 Transformation and Quality Strategy.
- CultureSeed recently onboarded four contract therapists who will help expand the organization’s capacity to provide one-on-one psychotherapy services for youth. Fifty percent of the contracted therapists are People of Color and will support efforts to reach and connect with more BIPOC youth.
- Klickitat County Health Department received two years of funding from the Washington State Department of Children, Youth, and Families to develop a task force to support perinatal mental health community capacity building. The task force includes community partners from Klickitat, Skamania, Wasco, and Hood River counties and is working to raise awareness on perinatal mental health issues, develop community resources and supports for families, and strengthen supports for healthcare and social service providers. The taskforce has received another two years of funding, during which the focus will be to increase provider-level training and education and develop perinatal mental health supports for families.
- CGHC and PacificSource Community Solutions convened the Behavioral Health Advisory Committee starting on July 20, 2021. This committee is a collaborative of people representing the behavioral health community across the Gorge including representatives from behavioral health provider organizations, social service agencies, the CCO, and members with lived experience from the Community Advisory Council (CAC). The group is currently working on potential strategies to address workforce development issues to improve equitable access to behavioral health care services. Once these strategies are determined, the group will raise these to the Clinical Advisory Panel (CAP), the health council board, and the state to request funding and resources to implement.

**Behavioral health care is equitable and inclusive, and offered in a respectful and trauma-informed manner.**

- The Columbia Gorge Resolution Center (CGRC) planning group received a \$50,000 planning grant from the OHA on October 1st, 2021. The OHA planning grant will fund strategic planning costs for the CGRC. The CGRC would add supporting infrastructure and programming services to address mental and behavioral health inequities in the Columbia River Gorge and could potentially co-locate with Mid-Columbia Community Action Council’s (MCCAC) Navigation Center in The Dalles to provide a one-stop mental, behavioral, addiction, housing, and transition service center.”  
([Source](#))

- The Perinatal Mental Health Initiative is working to secure funding to support up to 10 people to participate in the Perinatal Mental Health Certification Program, an online certification offered by Postpartum Support International. The taskforce will place an additional focus on training Spanish-speaking providers who can serve Latino/a community members.
- As a certified community behavioral health clinic (CCBHC), MCCFL continues efforts to integrate behavioral health with physical health care. This integrated approach includes efforts to engage and improve access for underserved groups including veteran, Hispanic/Latino/a, and Native American populations.
- CGHC is conducting a community visioning project funded through Providence to create a vision and implementation plan to improve access to culturally appropriate behavioral health services for the Latino/a community in the Gorge. The project focuses on expanding the traditional health worker workforce to provide additional behavioral health services. Traditional health workers have the potential to expand the bicultural/bilingual behavioral health workforce and address social determinants of health and equity (SDOH-E) factors that drive behavioral and mental health needs for underserved and marginalized populations. The project will wrap up in July of 2022 with implementation of the identified plan in the fall of 2022.

**Behavioral health care is offered in diverse settings which supports mental health and wellness at every stage of life.**

- As of spring 2022, CGESD coordinates behavioral telehealth services in middle and high schools in Wasco and Hood River Counties. Services are provided by One Community Health providers. Three students have received services since February 2022. One Community Health is organizing a formal back-to-school campaign to highlight these services for children and families before the 2022-23 school year.
- A CultureSeed staff member provides behavioral health services to youth at the Columbia High School Health and Wellness Center in White Salmon Valley School District. Anecdotally, the presence of trusted adults and services offered in the Center has increased youth sense of place and safety within the school.



**Behavioral Health Care Indicators**

Indicator	Data Source	Baseline Data (Year)	Progress Data (Year)
Increase number of school district nurses and/or ratio of school district nurses to students	Columbia Gorge Education Service District	School RN counts and ratios (2018-19): <ul style="list-style-type: none"> <li>▪ North Wasco County School District: 2.8 FTE with 1:1,430 ratio</li> <li>▪ Dufur School District: 0.3 FTE with 1:1,351 ratio</li> <li>▪ South Wasco County School District: 0.05 FTE with 1:5,929 ratio</li> </ul>	School RN counts and ratios (2021-22): <ul style="list-style-type: none"> <li>▪ North Wasco County School District: 3.2 FTE with 1:869 ratio</li> <li>▪ Dufur School District: 1.0 FTE with 1:345 ratio</li> <li>▪ South Wasco County School District: 0.05 FTE with 1:4,580 ratio</li> </ul>

Increase number of students seeking behavioral telehealth services	One Community Health	Not applicable – six Hood River and Wasco County schools started providing behavioral telehealth services in spring 2022.	Since February 2022, 3 students have received behavioral telehealth services in Wasco and Hood River counties.
Decrease emergency department admissions associated with opioid abuse in Hood River and Wasco Counties	Pacific Source (Collective Medical), Mid-Columbia Medical Center, Providence	Number of people who used the Providence or Mid-Columbia Medical Center Emergency Department due to Opioid Abuse (2020): <ul style="list-style-type: none"> <li>▪ Hood River County: 158 residents</li> <li>▪ Wasco County: 464 residents</li> <li>▪ Sherman County: 24 residents</li> </ul>	Progress data will be collected from Pacific Source (via Collective Medical) and/or records at Mid-Columbia Medical Center and Providence.



## 12 Health Care Coverage

### Strategy Updates

**People have stable medical coverage they can afford and when they use it, it does not cause financial distress.**

- Community Partner Outreach Program (CPOP) holds monthly collaboratives for Oregon Health Plan (OHP) Enrollment Assistants, key stakeholders, and community partners to share updates and emerging needs and resources related to health coverage.
- TNDI holds monthly calls for its Community Health Worker (CHW) Collaborative to connect and share resources. Each call hosts an average of 30 to 40 CHWs.

**Insurance covers the services people need, which include physical, dental, mental, and behavioral health.**

- OCH’s Mobile Medical Clinic, La Clínica, provides medical and behavioral health care to people throughout the Gorge. Services include insurance enrollment and financial aid application support. The clinic has served 265 patients since May 2022.

**Regardless of immigration status, create ways to ensure healthcare needs are met.**

- The Oregon Health Authority (OHA) is finalizing rollout for the Healthier Oregon Program, which will provide full OHP coverage to eligible individuals ages 19-25 or 55+, regardless of immigration status. An advisory group of CPOP members, OHA staff, and community members guided the program design. CPOP will guide outreach and engagement efforts to provide linguistically appropriate, plain language materials notifying OHP members of the new program. Approximately 200 people in Hood River and Wasco counties qualify for the program.





## Health Care Coverage Indicators

Indicator	Data Source	Baseline Data (Year)	Progress Data (Year)
Increase children living in Hood River and Wasco Counties who are enrolled in health insurance	American Community Survey (U.S. Census Bureau, Table ID: B27001)	Hood River County (2019): <ul style="list-style-type: none"> <li>Percent children under 19 with health insurance coverage: 97% (n = 5807/6004)</li> </ul> Wasco County (2019): <ul style="list-style-type: none"> <li>Percent children under 19 with health insurance coverage: 94% (n = 5815/6163)</li> </ul>	Hood River County (2020): <ul style="list-style-type: none"> <li>Percent children under 19 with health insurance coverage: 97% (n = 5830/6035)</li> </ul> Wasco County (2020): <ul style="list-style-type: none"> <li>Percent children under 19 with health insurance coverage: 93% (n = 5810/6229)</li> </ul>
Increase number students being served by School Based Health Centers	One Community Health	791 students served by School Based Health Center at Hood River Valley High School (2020-21)	508 students served by School Based Health Center at Hood River Valley High School (2021-22)



## 13 Promotion and Prevention



### Strategy Updates

**The information people need to support healthy choices is available to all.**

- Hood River County Prevention Department continues to host in-person and online parent workshops on topics that matter to parents. The workshops offer an opportunity to learn about resources available to parents and families and share ideas. Participants can attend the workshops in either English or Spanish language.
- YouthThink continues to host Toddlers2Teens (T2T) Boost Camps to support parents in better understanding and connecting with their children. In 2021, YouthThink hosted 18 T2T Boost Camps, with 47 participants representing parents of 63 children.

**Information and education on wellness, health promotion, and disease prevention are available and offered in an equitable and trauma informed way.**

- Wasco County and Hood River County Prevention are implementing Be-Strong Families Parent-Café trainings for parents and professionals who work with young people to promote stronger families, building connections, and increased resiliency. Four Rivers Early Learning Hub and Oregon Parenting Education Collaborative (OPEC) sponsored these trainings.

**Prevention and control of current and emerging health care issues are addressed in the community.**

- The Next Door, Inc., Columbia River Inter-Tribal Fish Commission, and One Community Health partnered to host COVID-19 vaccine clinics and conduct vaccine-related outreach to Native American communities in the Gorge.



**Promotion and Prevention Indicators**

Indicator	Data Source	Baseline Data (Year)	Progress Data (Year)
Decrease number and/or percent death by suicide in Hood River and Wasco County	Oregon Violent Death Reporting System	<p>Suicide Deaths for Youth Aged 10-24 by county (2019, 2020):</p> <ul style="list-style-type: none"> <li>▪ Hood River: 0 (2019), 0 (2020)</li> <li>▪ Wasco: 0 (2019), 1 (2020)</li> </ul> <p>Suicide Deaths for Adults 25 and older:</p> <ul style="list-style-type: none"> <li>▪ Hood River: 1 (2019), 3 (2020)</li> <li>▪ Wasco: 2 (2019), 9 (2020)</li> </ul>	<p>Suicide Deaths for Youth Aged 10-24 by county (2021):</p> <ul style="list-style-type: none"> <li>▪ Hood River: 1</li> <li>▪ Wasco: 1</li> </ul> <p>Suicide Deaths for Adults 25 and older:</p> <ul style="list-style-type: none"> <li>▪ Hood River: 5</li> <li>▪ Wasco: 8</li> </ul>
Decrease percent of suicide attempts among 8 <sup>th</sup> and 11 <sup>th</sup> graders in Wasco, Sherman and Hood River County	Oregon Student Health Survey (SHS) ( <a href="#">County Reports</a> and <a href="#">Data Dashboard</a> )	<p>Percent 8th and 11th graders who attempted suicide one or more times (2020):</p> <ul style="list-style-type: none"> <li>▪ Hood River County: 3.7% 8<sup>th</sup> graders, 2.9% 11<sup>th</sup> graders</li> <li>▪ North Central Health District (Sherman and Wasco Counties): 5.7% 8<sup>th</sup> graders, 10.2% 11<sup>th</sup> graders</li> </ul>	The SHS launched in schools with 6th, 8th and 11th graders in the fall of 2020 and will occur every even-numbered year. The next period of data collection is fall 2022.
Decrease number of overdose deaths	State Unintentional Drug Overdose Reporting System (SUDORS); Electronic Surveillance System for the Early Notification of Community-Based Epidemics (ESSENCE)	<p>Unintentional &amp; Undetermined Overdose Deaths (2019, 2020)</p> <ul style="list-style-type: none"> <li>▪ Hood River: 2 (2019), 0 (2020)</li> <li>▪ Wasco: 3 (2019), 5 (2020)</li> </ul>	<p>Unintentional &amp; Undetermined Overdose Deaths (2021):</p> <ul style="list-style-type: none"> <li>▪ Hood River: 4</li> <li>▪ Wasco: 7</li> </ul>

# APPENDICES

## Appendix A: Table of Indicators by Priority Area

Indicator	Data Source	Baseline Data (Year)	Progress Data (Year)
<b>Housing</b>			
Increase number of homeless veterans placed in permanent housing in the Gorge	Point-in-Time Count; Mid-Columbia Community Action Council	24 homeless Veterans in the Columbia Gorge (2019)	Mid-Columbia Community Action Council (2021): <ul style="list-style-type: none"> <li>Placed five veterans into permanent housing units in the Dalles</li> <li>Prevented homelessness for three veterans by providing veteran renter assistance</li> </ul>
Decrease number of individuals experiencing houselessness	Point-in-Time Count Mid-Columbia Community Action Council	Number of people experiencing houselessness (January 2020): <ul style="list-style-type: none"> <li>Hood River County: 56</li> <li>Wasco County: 112</li> <li>Sherman County: 11</li> </ul>	Number of people experiencing houselessness (January 2022): <ul style="list-style-type: none"> <li>Hood River County: 71</li> <li>Wasco County: 194</li> <li>Sherman County: 4</li> </ul> <p>Note: Increase in outreach efforts to houseless people in the Gorge may have contributed to increase in counts.</p>
Decrease number of cost-burdened and rent-burdened households  Note: Cost or rent-burdened = greater than 30 percent of gross household income is spent on monthly owner costs or gross rent	American Community Survey (U.S. Census Bureau, Table ID: <a href="#">DP04</a> )	Total cost-burdened households with a mortgage (2019): <ul style="list-style-type: none"> <li>Hood River County: 27.8% (n = 888/3,196)</li> <li>Wasco County: 29.7% (n = 1,098/3,703)</li> </ul> Total cost-burdened households without a mortgage (2019): <ul style="list-style-type: none"> <li>Hood River County: 11.4% (n =292/2,571)</li> <li>Wasco County: 12.3% (n =327/2,670)</li> </ul> Total rent-burdened households (2019): <ul style="list-style-type: none"> <li>Hood River County: 40.3% (n = 971/2,409)</li> <li>Wasco County: 36.4% (1,277/3,510)</li> </ul>	Total cost-burdened households with a mortgage (2020): <ul style="list-style-type: none"> <li>Hood River County: 30.6% (n=1,047/3,427)</li> <li>Wasco County: 30.4% (n = 1,157/3,800)</li> </ul> Total cost-burdened households without a mortgage (2020): <ul style="list-style-type: none"> <li>Hood River County: 11.6% (n= 305/2,640)</li> <li>Wasco County: 12.2% (n=344/2,822)</li> </ul> Total rent-burdened households (2020): <ul style="list-style-type: none"> <li>Hood River County: 38.4% (n = 914/2,382)</li> <li>Wasco County: 34.3% (n = 1,169/3,413)</li> </ul>

Indicator	Data Source	Baseline Data (Year)	Progress Data (Year)
Increase number of affordable rental ownership opportunities available	<a href="#">Affordable Rental Housing Dashboard</a> by Oregon Housing and Community Services (OHCS)  (via <a href="#">Oregon Housing Data &amp; Analysis</a> )	OHCS-funded properties (as of December 2020): <ul style="list-style-type: none"> <li>Hood River County: 26 total units, 10 total projects</li> <li>Wasco County: 24 total units, 3 total projects</li> </ul>	OHCS-funded properties (as of December 2021): <ul style="list-style-type: none"> <li>Hood River County: 26 total units, 10 total projects</li> <li>Wasco County: 24 total units, 3 total projects</li> </ul>
<b>Food</b>			
Decrease rate of food insecurity	<a href="#">Feeding America: Map the Meal Gap</a>	Food insecurity rate and number of food insecure people by county (2019): <ul style="list-style-type: none"> <li>Hood River: 6.6% (n = 1,540)</li> <li>Wasco: 11.8% (n = 3,080)</li> <li>Gilliam: 12.1% (n = 230)</li> <li>Sherman: 13.4% (n = 220)</li> <li>Wheeler: 13.6% (n = 190)</li> </ul>	The most recent data release is based on data from 2019, before COVID-19. In 2021, Feeding America released data on <i>projected</i> changes in food insecurity as a result of COVID-19. Projected food insecurity rates by county (2021): <ul style="list-style-type: none"> <li>Hood River: 7.9%</li> <li>Wasco: 12.8%</li> <li>Gilliam: 13.1%</li> <li>Sherman: 14.1%</li> <li>Wheeler: 13.7%</li> </ul>
<b>Transportation and Mobility</b>			
Increase number of Gorge Passes provided to low-income people in the Gorge	Columbia Area Transit	No baseline data available.	Number of Gorge Passes distributed since July 2021: <ul style="list-style-type: none"> <li>Hood River County = 256</li> <li>Wasco County = 196</li> </ul>
<b>Improved Access to Equitable Physical Activity and the Outdoors</b>			
Decrease percent of 8 <sup>th</sup> and 11 <sup>th</sup> graders who are overweight or obese	Oregon Student Health Survey (SHS) ( <a href="#">County Reports</a> and <a href="#">Data Dashboard</a> )	Percent 8th and 11th graders who are overweight (2020): <ul style="list-style-type: none"> <li>Hood River County: 15.9% 8th graders, 14.1% 11<sup>th</sup> graders</li> <li>North Central Health District (Sherman and Wasco Counties): 15.5% 8th graders, 19.2% 11th graders</li> </ul> Percent 8th and 11th graders who are obese (2020): <ul style="list-style-type: none"> <li>Hood River County: 12.1% 8th graders, 8.2% 11<sup>th</sup> graders</li> <li>North Central Health District (Sherman and Wasco Counties): 21.0% 8th graders, 18.4% 11th graders</li> </ul>	The SHS launched in schools with 6th, 8th and 11th graders in the fall of 2020 and will occur every even-numbered year. The next period of data collection is fall 2022.

Youth Safety			
Decrease percent youth who identify mental and behavioral health challenges as top concerns facing students in schools	Baseline data: Youth & Parent Survey (Wasco County, December 2020)  Progress data: YouthThink, <a href="#">Search Institute Developmental Relationships Survey</a>	In the Youth & Parent Survey administered for the School Health Services Planning Grant in Wasco County (December 2020), youth identified the top three health concerns facing students in schools as: 1) Mental health: feeling sad, stressed, thinking about hurting yourself, 2) Alcohol or drug use, and 3) Smoking, vaping.	In 2022-23, YouthThink will begin administering the Search Institute Developmental Relationships Survey for 4 <sup>th</sup> to 12 <sup>th</sup> grade students and staff in Wasco County. The survey will provide ongoing data on youth and adults perceptions of student mental and behavioral health.
Decrease percent parents who are concerned about their child's mental health and behavioral health	YouthThink  Baseline data: Youth & Parent Survey (Wasco County, December 2020)	Prior to the COVID-19 pandemic, YouthThink conducted yearly parent surveys at elementary and middle schools to identify parent concerns and perceptions of their child's health. The survey has collected over 600 responses.  During the COVID-19 pandemic, the Youth & Parent Survey administered for the School Health Services Planning Grant in Wasco County (December 2020) asked parents questions on the impact of COVID-19 on their children. 58% of parents reported their child seems sad or lonely from being unable to see their friends or people they care about due to COVID-19.	The parent survey administered by YouthThink will be resumed in the 2022-23 school year.
Early Childhood Development and Child Care			
Increase number of elementary school zones that offer options for high quality childcare programs that represent the demographics of the zone	Mid-Columbia Children's Council (MCCC)	No baseline data available.	MCCC operates 21 preschool classrooms, 7 infant toddler classrooms and 6 home-based models (for 0-3 year olds) in four counties: Skamania, Klickitat, Wasco, and Hood River. Their programs reach all elementary school zones in the four counties they serve (2022).

Sense of Community			
Decrease percent of 8 <sup>th</sup> and 11 <sup>th</sup> graders who are bullied going to or at school	Oregon Student Health Survey (SHS) ( <a href="#">County Reports</a> and <a href="#">Data Dashboard</a> )	<p>Percent 8th and 11th graders bullied in the past 30 days AT SCHOOL (in-person OR via social media, phones, gaming)</p> <ul style="list-style-type: none"> <li>Hood River County: 8.2% 8th graders, 11.4% 11th graders</li> <li>North Central Health District (Sherman and Wasco Counties): 7.7% 8th graders, 21.3% 11th graders</li> </ul> <p>Note: County-level data was not available for Gilliam County.</p>	The SHS launched in schools with 6th, 8th and 11th graders in the fall of 2020 and will occur every even-numbered year. The next period of data collection is fall 2022.
Decrease percent of 8 <sup>th</sup> and 11 <sup>th</sup> graders who miss school because they feel unsafe	Oregon Student Health Survey (SHS) ( <a href="#">County Reports</a> and <a href="#">Data Dashboard</a> )	<p>Percent 8th and 11th graders who did not go to school in the past 30 days because they felt they would be unsafe at school or on their way to or from school (2020):</p> <ul style="list-style-type: none"> <li>Hood River County: 3.8% 8th graders, 2.6% 11th graders</li> <li>North Central Health District (Sherman and Wasco Counties): 10.2% 8th graders, 7% 11th graders</li> </ul> <p>Note: County-level data was not available for Gilliam County.</p>	The SHS launched in schools with 6th, 8th and 11th graders in the fall of 2020 and will occur every even-numbered year. The next period of data collection is fall 2022.
Collaboration and Information Sharing			
Increase number organizations using an adopted referral system that links healthcare and social services agencies in the Gorge	Pacific Source and Columbia Gorge Health Council	Community Information Exchange (CIE) is expanding across the state with Connect Oregon, and slowly growing in the Columbia Gorge. Activate Care and Connect Oregon are currently present in the region. The Gorge has a regional goal of ensuring platforms used have as much interoperability as possible. Currently, PacificSource and CGHC are driving the process of interoperability between Activate Care and Unite Us. As of June 2021, 7 organizations were onboarded to Activate Care.	Connect Oregon, via the Unite Us platform, is currently being explored for adoption in the Gorge for social service and healthcare partners to send closed loop referrals. Organizations in South Wasco County are exploring a pilot to launch in August 2022. Additionally, Bridges to Health is currently exploring utilizing Connect Oregon to connect clients with PacificSource for flexible services. As of June 2022, there are ten organizations in the Gorge actively using Activate Care.



Decrease percent of unmet client needs across Behavioral Health, Housing, Childcare and Dental	Bridges to Health	The highest percent of client needs unable to be met (incomplete percentages), according to Bridges to Health Program Data (June 2021) were: <ul style="list-style-type: none"> <li>▪ Childcare (20%)</li> <li>▪ Behavioral Health (16%)</li> <li>▪ Dental (15%)</li> <li>▪ Employment (15%)</li> <li>▪ Housing (12%)</li> <li>▪ Medical (5.5%)</li> </ul>	The highest percent of client needs unable to be met (incomplete percentages), according to Bridges to Health Program Data (June 2022) are: <ul style="list-style-type: none"> <li>▪ Employment (22%)</li> <li>▪ Childcare (21%)</li> <li>▪ Behavioral Health (20%)</li> <li>▪ Housing (16.7%)</li> <li>▪ Dental (12.7%)</li> <li>▪ Medical (10.8%)</li> </ul> <p>Dental has improved by 2.3% since June 2021.</p>
Increase number of Bridges to Health program clients successfully navigated to services with an emphasis on under resourced populations (older adults, tribal members, and migrant and seasonal farm workers)	Bridges to Health	During the last quarter in 2020 and the first quarter in 2021, clients of the Bridges to Health Program were navigated successfully to the following services in order of frequency: Food, Financial Assistance, Housing, Social Services, Utility Assistance, Transportation, Medical Visits, and COVID Immunizations. 733 needs were addressed successfully through service navigation.	Since second quarter 2021, clients of the Bridges to Health Program were navigated successfully to the following services: Food, Financial Assistance, Housing, Social Services, Utility Assistance, Transportation, Medical Visits, and COVID Immunizations. 1560 needs were addressed successfully through service navigation.
<b>Primary Care</b>			
Decrease percent of patients whose most recent HbA1C level is greater than 9%	Pacific Source Quality Incentive Measure (QIM) Performance Report	Gorge CCO rate of patients' whose most recent HbA1C level is greater than 9% (2020): 26.4% <p>Note: CCO performance is measured by data from One Community Health, Mid-Columbia Medical Center, Columbia Gorge Family Medicine and Providence. CCO targets were rebased in August 2021.</p>	Gorge CCO rate of patients' whose most recent HbA1C level is greater than 9% (2021): 25.4% (Target 33.3%) <p>Note: CCO performance is measured by data from One Community Health, Mid-Columbia Medical Center, Columbia Gorge Family Medicine and Providence. CCO targets were rebased in August 2021.</p>
Increase or consistent high level (95% or above) of Columbia Gorge CCO members assigned to a patient-centered primary care home (PCPCH)	PacificSource Gorge CCO	Percent members enrolled in the Columbia Gorge CCO who are assigned to a PCPCH (2021): 94%	Percentage members enrolled in the Columbia Gorge CCO who are assigned to a PCPCH (2022): 96%

Increase percent children (age 3-6 and Columbia Gorge CCO members) that receive an annual wellness visit with their Primary Care Provider	PacificSource	Percent children (age 3-6 and Columbia Gorge CCO members) that receive an annual wellness visit with their Primary Care Provider (2021): 904 children (71.1% of children enrolled in the CCO)	Percent children (age 3-6 and Columbia Gorge CCO members) that receive an annual wellness visit with their Primary Care Provider (January-April 2022): 351 children (21.8% of children enrolled in the CCO)
<b>Dental Care</b>			
Increase percent of Gorge CCO children ages 1-5 who received oral health services	Pacific Source Quality Incentive Measure (QIM) Performance Report	Gorge CCO rate of children receiving oral health services (February 2021): <ul style="list-style-type: none"> <li>Age 1-5: 8.3%</li> </ul>	Gorge CCO rate of children receiving oral health services (December 2021): <ul style="list-style-type: none"> <li>Age 1-5: 40.6% (Target 33.7%)</li> <li>Age 6-14: 59.3% (Target 43.1%)</li> </ul> Gorge CCO rate of children receiving oral health services (April 2022): <ul style="list-style-type: none"> <li>Age 1-5: 15.9% (Target 39.4%)</li> <li>Age 6-14: 20.6% (Target 52%)</li> </ul> Note: CCO targets were rebased in August 2021.
<b>Behavioral Health Care</b>			
Increase number of school district nurses and/or ratio of school district nurses to students	Columbia Gorge Education Service District	School RN counts and ratios (2018-19): <ul style="list-style-type: none"> <li>North Wasco County School District: 2.8 FTE with 1:1,430 ratio</li> <li>Dufur School District: 0.3 FTE with 1:1,351 ratio</li> <li>South Wasco County School District: 0.05 FTE with 1:5,929 ratio</li> </ul>	School RN counts and ratios (2021-22): <ul style="list-style-type: none"> <li>North Wasco County School District: 3.2 FTE with 1:869 ratio</li> <li>Dufur School District: 1.0 FTE with 1:345 ratio</li> <li>South Wasco County School District: 0.05 FTE with 1:4,580 ratio</li> </ul>
Increase number of students seeking behavioral telehealth services	One Community Health	Not applicable – six Hood River and Wasco County schools started providing behavioral telehealth services in spring 2022.	Since February 2022, 3 students have received behavioral telehealth services in Wasco and Hood River counties.
Decrease emergency department admissions associated with opioid abuse in Hood River and Wasco Counties	Pacific Source (Collective Medical), Mid-Columbia Medical Center, Providence	Number of people who used the Providence or Mid-Columbia Medical Center Emergency Department due to Opioid Abuse (2020): <ul style="list-style-type: none"> <li>Hood River County: 158 residents</li> <li>Wasco County: 464 residents</li> <li>Sherman County: 24 residents</li> </ul>	Progress data will be collected from Pacific Source (via Collective Medical) and/or records at Mid-Columbia Medical Center and Providence.

Health Coverage			
Increase children living in Hood River and Wasco Counties who are enrolled in health insurance	American Community Survey (U.S. Census Bureau, Table ID: B27001)	<p>Hood River County (2019):</p> <ul style="list-style-type: none"> <li>Percent children under 19 with health insurance coverage: 97% (n = 5807/6004)</li> </ul> <p>Wasco County (2019):</p> <ul style="list-style-type: none"> <li>Percent children under 19 with health insurance coverage: 94% (n = 5815/6163)</li> </ul>	<p>Hood River County (2020):</p> <ul style="list-style-type: none"> <li>Percent children under 19 with health insurance coverage: 97% (n = 5830/6035)</li> </ul> <p>Wasco County (2020):</p> <ul style="list-style-type: none"> <li>Percent children under 19 with health insurance coverage: 93% (n = 5810/6229)</li> </ul>
Increase number students being served by School Based Health Centers	One Community Health	791 students served by School Based Health Center at Hood River Valley High School (2020-21)	508 students served by School Based Health Center at Hood River Valley High School (2021-22)
Promotion and Prevention			
Decrease number and/or percent death by suicide in Hood River and Wasco County	Oregon Violent Death Reporting System	<p>Suicide Deaths for Youth Aged 10-24 by county (2019, 2020):</p> <ul style="list-style-type: none"> <li>Hood River: 0 (2019), 0 (2020)</li> <li>Wasco: 0 (2019), 1 (2020)</li> </ul> <p>Suicide Deaths for Adults 25 and older:</p> <ul style="list-style-type: none"> <li>Hood River: 1 (2019), 3 (2020)</li> <li>Wasco: 2 (2019), 9 (2020)</li> </ul>	<p>Suicide Deaths for Youth Aged 10-24 by county (2021):</p> <ul style="list-style-type: none"> <li>Hood River: 1</li> <li>Wasco: 1</li> </ul> <p>Suicide Deaths for Adults 25 and older:</p> <ul style="list-style-type: none"> <li>Hood River: 5</li> <li>Wasco: 8</li> </ul>
Decrease percent of suicide attempts among 8 <sup>th</sup> and 11 <sup>th</sup> graders in Wasco, Sherman and Hood River County	Oregon Student Health Survey (SHS) ( <a href="#">County Reports</a> and <a href="#">Data Dashboard</a> )	<p>Percent 8th and 11th graders who attempted suicide one or more times (2020):</p> <ul style="list-style-type: none"> <li>Hood River County: 3.7% 8<sup>th</sup> graders, 2.9% 11<sup>th</sup> graders</li> <li>North Central Health District (Sherman and Wasco Counties): 5.7% 8<sup>th</sup> graders, 10.2% 11<sup>th</sup> graders</li> </ul>	The SHS launched in schools with 6th, 8th and 11th graders in the fall of 2020 and will occur every even-numbered year. The next period of data collection is fall 2022.
Decrease number of overdose deaths	State Unintentional Drug Overdose Reporting System (SUDORS); Electronic Surveillance System for the Early Notification of Community-Based Epidemics (ESSENCE)	<p>Unintentional &amp; Undetermined Overdose Deaths (2019, 2020)</p> <ul style="list-style-type: none"> <li>Hood River: 2 (2019), 0 (2020)</li> <li>Wasco: 3 (2019), 5 (2020)</li> </ul>	<p>Unintentional &amp; Undetermined Overdose Deaths (2021):</p> <ul style="list-style-type: none"> <li>Hood River: 4</li> <li>Wasco: 7</li> </ul>

## Appendix B: CHP Partners Who Contributed to the Progress Report

**Al Barton**, *Deputy Director*, Mid-Columbia Center For Living  
**Alison Donnelly**, *Whole Child Nurse Administrator*, Columbia Gorge Education Service District  
**Amy Sugg**, *Director of Case Management*, Mid-Columbia Medical Center  
**Belinda Ballah**, *Director*, Hood River County Prevention Department  
**Bentley Barbour**, *Counseling Administrative Supervisor*, The Next Door, Inc.  
**Chelsea Ruder**, *Community Research Liaison*, Oregon Health and Science University  
**Deana Maher**, *Regional Outreach Coordinator*, OHA-Community Partner Outreach Program  
**Debby Jones**, *Wasco County Prevention Specialist*, YouthThink  
**Elke Geiger**, *Columbia Gorge CCO Director*, PacificSource Community Solutions  
**Gaby Swisher**, *Behavioral Health Strategist*, PacificSource Community Solutions  
**Gladys Rivera**, *Director of Preventative Health*, One Community Health  
**Jake Dilla**, *Behavioral Health Performance Coach*, PacificSource Community Solutions  
**Jennifer Pauletto**, *Food Security Coalition Coordinator*, Gorge Grown Food Network  
**Jenny Anglin**, *Executive Director*, Columbia Gorge Health Council  
**Kathy Fitzpatrick**, *Mobility Manager*, Mid-Columbia Economic Development District  
**Kay Alton**, *Behavioral Health Director*, CultureSeed  
**Kenny LaPoint**, *Executive Director*, Mid-Columbia Community Action Council  
**Kristen Nicolescu**, *School-Based Health Center Clinic Manager*, One Community Health  
**Lauren Kraemer**, *Associate Professor, Family and Community Health*, OSU Extension Service  
**Lexi Stickel**, *Senior Community Health Coordinator*, PacificSource Community Solutions  
**Mark Hickok**, *District Director*, Hood River Valley Parks and Recreation District  
**Melanie Kelly**, *Director of Programs, Treatment and Youth Services*, The Next Door, Inc.  
**Nicole Schrankel**, *Population Health Strategist*, PacificSource Health Plans  
**Patty Lara-Martinez**, *CHW Collaborative Coordinator*, The Next Door, Inc.  
**Ryan Daven**, *Medicaid Behavioral Health Population Health Manager*, PacificSource Community Solutions  
**Sara Crook**, *Mobility and Travel Training Program Manager*, Mid-Columbia Economic Development District  
**Sarah Sullivan**, *Executive Director*, Gorge Grown Food Network  
**Scott Baker**, *District Director*, Northern Wasco Parks and Recreation District  
**Sharon Thornberry**, *Manager*, Columbia Gorge Food Bank  
**Suzanne Cross**, *Senior Program Manager*, Columbia Gorge Health Council  
**Trish Elliott**, *Director*, Hood River County Health Department  
**Velvet Cooley**, *Chief Operating Officer*, Mid-Columbia Children's Council, Inc.

## Appendix C: Documents Reviewed for the Progress Report

[\\$3.1M grant funds year-round pallet homes in The Dalles](#)  
[Affordable Rental Housing Dashboard \(Oregon Housing and Community Services\)](#)  
[Be Strong Families](#)  
[Columbia Gorge Food Bank receives \\$100,000 from Google](#)  
[Columbia Gorge Food Bank Seeks City Approval for Renovations](#)  
[Columbia Gorge Resolution Center Awarded \\$50,000 OHA Planning Grant](#)  
[Conversations Across the Food System \(2013\), Oregon Food Bank](#)  
[CultureSeed Outdoor Mentorship Program](#)  
[Google awards CGFB \\$100,000 Community Food Systems Grants](#)  
[Gorge Grown Food Network 2019-21 Impact Report](#)  
[Healthier Oregon Program](#)  
[Healthier Together Oregon, 2020-2024 State Health Improvement Plan](#)  
[Hood River County Prevention Department Parent Workshops](#)  
[Hood River Library of Things](#)  
[Hood River Safe Routes to School Plan](#)  
[Hood River Shelter Services Gets a New Location](#)  
[How the Gorge Community is Coming Together to Distribute the COVID Vaccine](#)  
[La Clínica Mobile, One Community Health](#)  
[Map the Meal Gap, Feeding America](#)  
[Mid-Columbia Community Action Council Health and Housing Integration](#)  
[Mid-Columbia Community Action Council Navigation Center Fact Sheet](#)  
[Mid-Columbia Community Action Council Receives \\$1.5 Million to Develop Navigation Center in The Dalles](#)  
[Mid-Columbia Children’s Council 2020-21 Annual Report](#)  
[Mid-Columbia Children’s Council Parent Policy Council](#)  
[Mid-Columbia Medical Center Opens Transitional Care Clinic](#)  
[Mobile ‘La Clínica’ debuts in Gorge](#)  
[Northern Wasco County Parks & Rec awarded \\$2.6M for Mill Creek Greenway construction](#)  
[One Community Health Celebrates Launch of New Mobile Clinic “La Clínica” with Launch Parties throughout the Community](#)  
[Oregon Preschool Promise](#)  
[Oregon Student Health Survey, Hood River County 2020 Report](#)  
[Oregon Student Health Survey, North Central Health District 2020 Report](#)  
[Postpartum Support International: Certification in Perinatal Mental Health](#)  
[School-Based Health Centers Fact Sheet](#)  
[School-Based Virtual Behavioral Health Services, One Community Health](#)  
[Search Institute Developmental Relationships Survey](#)  
[Shelter for Houseless More than Doubles in TD and HR](#)  
[StrongPeople Exercise Videos](#)  
[Substance Use Disorder \(SUD\) Technical Assistance Toolkit Summary \(provided by PacificSource\)](#)  
[Teen Intervene](#)  
[Tobacco Retail License Fact Sheet, Oregon Health Authority](#)  
[YouthThink T2T Boost Camps](#)